

THE BUSINESS CENTRE



727 Collins Street, Melbourne
collinssquare.com.au

THE BUSINESS CENTRE

The Business Centre offers private suites that are flexible, sophisticated meeting and project spaces designed to exceed your expectations.

Our 23 purpose built business suites accommodating from 3 to 30 guests in unparalleled style.

Every suite is equipped with the latest in audio visual, tele-presence and soundproofing technology, and is serviced by our personal meeting concierges.

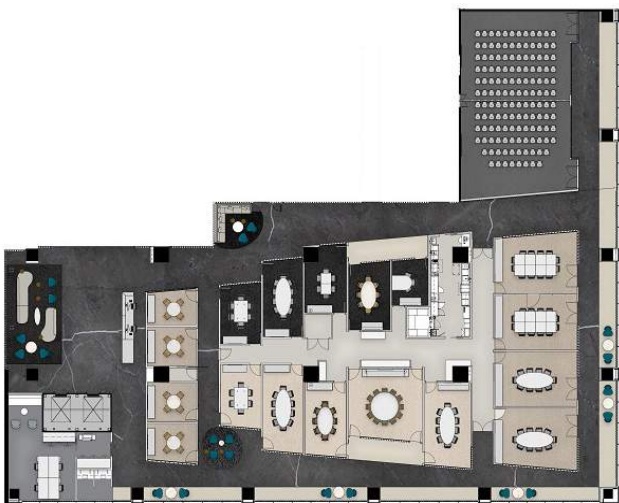



MENU OPTIONS

We offer a comprehensive range of menus for The Business Centre, so that your guests are looked after from the moment they arrive until they depart. Lunch is available with service starting between 11:30am and 1:30pm, concluding no later than 3:00pm.

DAY DELEGATE

Package One.....\$92.50

Full conference package which includes arrival beverages, morning and afternoon tea plus a premium sandwich lunch. This package includes room hire and use of the in-house AV system.

Half Day Delegate Package.....\$75.50

As per the above but for a maximum of four hours.

Package Two.....\$105.00

As per the above but served with a buffet lunch

Package Three.....\$110.00

As per the above but served with a two course alternative drop plated lunch.

Create your own style of event from the options below:

ON ARRIVAL

Guests are greeted on arrival with assorted teas, filtered coffee, juices and mineral water.....\$7.50 per person

If you are hosting an all-day event, then the above offer can be replenished throughout the day.....\$15 per person

MORNING AND AFTERNOON TREATS

A variety of savory and sweet options.....\$7.50 per person

ADDITIONAL OPTIONS

Canapés prior to lunch..... \$12 per person

Two pieces per person

Alternative Drop..... \$5 per person

Entrée or desert alternative

Side Dishes..... \$2.50 per person

Served to the table for guests to share

LUNCH MENU OPTIONS

The Business Centre offers a variety of lunch dining options to suit your requirements and availability of time.

All lunches are delivery to your Suite by our butler staff as specified in your running sheet with a minimum amount of intrusion.

Our offer includes assorted teas and fresh filter coffee plus orange juice and mineral water.

Working Sandwich Lunch.....\$50 per person

A mixture of sandwiches, rolls and wraps served with mini fritatta and quiches plus two fresh salads and a seasonal sliced fruits.

Buffet Lunch.....\$65 per person

A mixture of hot and cold self-serve dishes plus a dessert offering and fruit platter. This menu is designed to be eaten as a seated option.

Seated Lunch

A set or limited 'a la carte' menu tailored for you individually, consisting of two or three courses.

Additional staffing charges apply for this option.

Set menu of two courses.....\$65 per person

Set menu of three courses.....\$80 per person

Degustation

Our Signature four course degustation menu serves the same meal per guests with optional wine matching.

Four course degustation.....\$110 per person

All our menus offer the very best ingredients and represents seasonal availability.

Dietary Requirements

Dietary requirements can be accommodated in addition to the menu and must be advised seven days prior to the event.

SAMPLE SEATED LUNCH MENU

The below represents a sample of one of our three course a la carte menu offers

Entrée

Blue swimmer crab cake, compressed watermelon, caper mayonnaise

OR

Black Angus carpaccio, wild mushrooms, pecorino, bitter leafs

Main Course

Confit organic duck leg, toasted grains, pickled baby beetroot, cumin scented yoghurt

OR

Braised beef cheek, parsnip puree, piquillo peppers, grilled spring

Dessert

Belgian chocolate fondant, dulce de leche ice cream, coco nibs

OR

Apple & rhubarb crumble, vanilla and candied almond ice cream

Petits fours

All menus are subject to change without notice due to seasonal availability.

Full menu upon request.



BEVERAGE LIST

Choosing wine in advance for your event ensures we have enough stock on hand. Our team of sommeliers can assist with these choices at any time. Please note that wine availability & vintages are subject to change & can be confirmed closer to the date of your event.

BEVERAGE OPTIONS

- Beverages charged on consumption
- Beverage packages for various durations at a per person price
- Wine matches designed to accompany each course of the menu at a per person price

SPARKLING/CHAMPAGNE

Vine and Sea Brut, South Australia.....	\$30
Redbank Prosecco, King Valley, VIC.....	\$44
Airlie Bank Brut, Yarra Valley, VIC.....	\$55
Segura Cava, Penedes, Spain.....	\$49
Jansz Premium Cuvee, Tasmania.....	\$68
Pol Roger Brut, Champagne, France.....	\$120

WHITE

Kindred Spirits Sauvignon Blanc, Marlborough, NZ.....	\$32
Nautilus Sauvignon Blanc, Marlborough, NZ.....	\$62
Redbank The Long Paddock Pinot Grigio, King Valley, VIC.....	\$34
Martinborough Pinot Gris, Martinborough, NZ.....	\$55
Punt Road Chardonnay, Yarra Valley, VIC.....	\$56

ROSE

Tarrawarra Rose, Yarra Valley, VIC.....	\$54
---	------

RED

Palliser 'Pencarrow' Pinot Noir, Martinborough, NZ.....	\$56
Pacha Mama Shiraz, Heathcote, VIC.....	\$54
Heartland 'Stickleback' Shiraz blend, Langhorne Creek, SA.....	\$34
Yangarra Tempranillo, McLaren Vale, SA.....	\$55
Earthworks Cabernet Sauvignon, Barossa Valley, SA.....	\$36

SOFT DRINK

Soft drinks and juices.....	\$5
-----------------------------	-----

BEER

Asahi, Cricketers Arms, Mountain Goat.....	\$9
--	-----

BEVERAGE PACKAGES

We offer three different beverage packages to compliment your event.

Please note wine selections subject to availability.

All beverage packages include tap beer, mineral water and a selection of soft drinks.

Beverage Package One

Please select a choice of one white wine and one red wine from the following options.

Two hours.....	\$30 per person
Three hours.....	\$40 per person
Four hours.....	\$50 per person
Five hours.....	\$60 per person

- Vine and Sea Brut, SA - on arrival
- Kindred Spirits Sauvignon Blanc, Marlborough, NZ
- Redbank The Long Paddock Pinot Grigio, King Valley, VIC
- Earthworks Cabernet Sauvignon, Barossa Valley, SA
- Heartland 'Stickleback' Shiraz blend, Langhorne Creek, SA
- Cricketers 'Keepers Lager'

Beverage Package Two

Please select a choice of one sparkling, one white wine and one red wine from the following options.

Two hours.....	\$40 per person
Three hours.....	\$50 per person
Four hours.....	\$60 per person
Five hours.....	\$70 per person

- Redbank Prosecco, King Valley, VIC
- Airlie Bank Brut, Yarra Valley, VIC
- Segura Cava, Penedes, Spain
- Punt Road Chardonnay, Yarra Valley, VIC
- Martinborough Pinot Gris, Martinborough, NZ
- Nautilus Sauvignon Blanc, Marlborough, NZ
- Palliser Estate Pencarrow Pinot Noir, Martinborough, NZ
- Yangarra Tempranillo, McLaren Vale, SA
- Pacha Mama Shiraz, Heathcote, VIC
- Boatrockers Pale Ale

Champagne add on for any package \$30pp for three hours

- NV Pol Roger Brut, Champagne, France

COLLINS IV
SQUARE III

727 Collins Street, Melbourne
collinssquare.com.au